

# A38 Derby Junctions

## TR010022

### 8.113 Markeaton Junction Potential Footway Diversions During Scheme Construction

Planning Act 2008

Rule 8 (1)(c)(ii)

The Infrastructure Planning (Examination Procedure) Rules 2010

Volume 8

June 2020

Infrastructure Planning

Planning Act 2008

The Infrastructure Planning (Examination Procedure) Rules 2010

A38 Derby Junctions  
Development Consent Order 202[ ]

---

**Markeaton Junction Potential Footway Diversions During Scheme  
Construction**

---

<b>Regulation Number</b>	Rule 8(1)(c)(ii)
<b>Planning Inspectorate Scheme Reference</b>	TR010022
<b>Application Document Reference</b>	TR010022/APP/8.113
<b>Author</b>	A38 Derby Junctions Project Team, Highways England

<b>Version</b>	<b>Date</b>	<b>Status of Version</b>
1	18 June 2020	Deadline 14 Submission

## Markeaton Junction Potential Footway Diversions During Scheme Construction

### 1. Introduction

- 1.1.1 During issue Specific Hearing (ISH) 8 (10 June 2020), the Examining Authority (ExA) requested a plan that shows the locations of potential air quality exceedances associated with footways in the vicinity of Markeaton junction during the Scheme construction phase, together with potential temporary footpath diversion routes.
- 1.1.2 The plan included herein illustrates footways that may need to be closed during the Scheme construction phase, together with potential temporary diversion routes and diversion distances. Such footpath diversions may be required for air quality zonal compliance and/ or health and safety reasons. All potential alternative routes use existing footways. The need for such temporary footpath diversions during the Scheme construction phase (or parts thereof) will be determined during the Scheme detailed design stage. It is noted that in accordance with the Outline Environmental Management Plan (OEMP) [REP12-002], Highways England will seek to agree temporary diversion routes in advance with the applicable local authorities. The OEMP also states that appropriate signage for all footpath diversions will be provided to inform pedestrians and cyclists, with sufficient notice of such diversions also being provided.
- 1.1.3 The plan provided herein has been reviewed by Derby City Council (DCiC) who have stated that in principle the diversion routes could be acceptable, although further details will need to be discussed. The provisions as included in the OEMP commit to further consultation with DCiC during the definition of all footpath and cycleway diversions (during the Scheme detailed design stage).

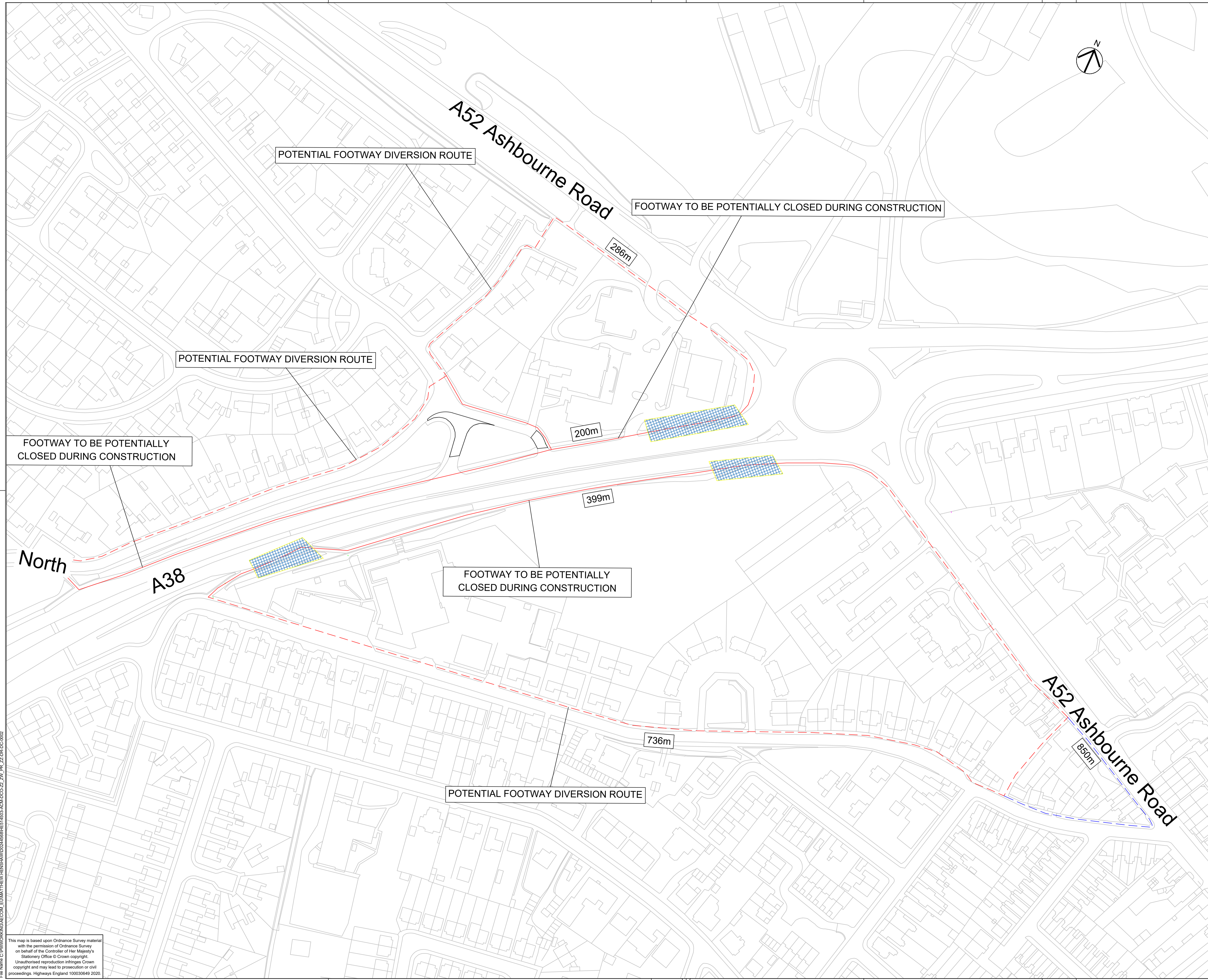

- NOTES**
1. THIS DRAWING IS TO BE READ IN CONJUNCTION WITH ALL OTHER RELEVANT DOCUMENTATION.
  2. DO NOT SCALE FROM THIS DRAWING, USE ONLY PRINTED DIMENSIONS.
  3. ALL DIMENSIONS IN METRES, ALL CHAINAGES, LEVELS AND COORDINATES ARE IN METRES UNLESS DEFINED OTHERWISE.

- KEY**
- SECTION OF FOOTWAY AT RISK OF AIR QUALITY NON-COMPLIANCE IN 2021.
  - FOOTWAY THAT MAY REQUIRE TEMPORARY CLOSURE DURING CONSTRUCTION
  - EXISTING FOOTWAYS AVAILABLE AS DIVERSIONARY ROUTES.
  - EXISTING FOOTWAYS AVAILABLE AS DIVERSIONARY ROUTES

First Issue	MSH	18/06/20	P01
Revision Details	By	Date	Suffix
	AW		
	Check		

Purpose of issue  
**FOR STAGE APPROVAL**

Client  
Highways England  
Floor 5  
Two Colmore Square  
38 Colmore Circus  
Birmingham  
B4 6BN



Development Consent Order Number  
**TR010022**

Project Title  
**A38  
DERBY JUNCTIONS**

Drawing Title  
**MARKEATON JUNCTION  
POTENTIAL FOOTWAY  
DIVERSIONS DURING  
CONSTRUCTION**

Designed	Drawn	Checked	Approved	Date
LF	MSH	GS	AW	18/06/20
Internal Project No.	Suitability			
60533462	S4			
Scale @ A1	Zone			
1:1000	A38/A52 Markeaton			

THIS DOCUMENT HAS BEEN PREPARED PURSUANT TO AND SUBJECT TO THE TERMS OF AECOM'S APPOINTMENT BY ITS CLIENT. AECOM ACCEPTS NO LIABILITY FOR ANY USE OF THIS DOCUMENT OTHER THAN BY ITS ORIGINAL CLIENT OR FOLLOWING AECOM'S EXPRESS AGREEMENT TO SUCH USE, AND ONLY FOR THE PURPOSES FOR WHICH IT WAS PREPARED AND PROVIDED.

Drawing Number	Highways England PIN	I Originator	I Volume	Rev
HE514503	-ACM	-DCO		P01
Z2_ZW_PR_ZZ		-DR-DC-0002		
Location	I Type	I Role	I Number	

File Path: C:\Users\jg2020\OneDrive\Documents\A38\A52\DCO\Z2\_ZW\_PR\_ZZ-DCO-0002  
 File Name: C:\Users\jg2020\OneDrive\Documents\A38\A52\DCO\Z2\_ZW\_PR\_ZZ-DCO-0002

This map is based upon Ordnance Survey material with the permission of Ordnance Survey on behalf of the Controller of Her Majesty's Stationery Office © Crown copyright. Unauthorised reproduction infringes Crown copyright and may lead to prosecution or civil proceedings. Highways England 100030649 2020.